

## SIZE IN MILLIMETERS

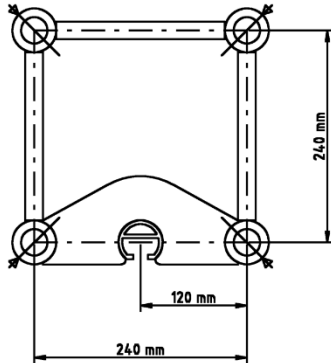

## SIZE IN INCHES

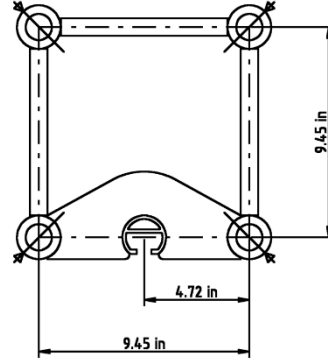

## SPECIFICATIONS

<b>Tubes</b>	50 x 4 mm (1.97 x 0.16 in)
<b>Braces</b>	20 x 2 mm (0.79 x 0.08 in)
<b>Alloy</b>	EN AW-6082 T6

## LOADING TABLES – COMPLETE TRUSS

	4 m	5 m	6 m	7 m	8 m	10 m	12 m	14 m	16 m	18 m	20 m
UDL [kg/m]	746	594	456	331	251	155	104	73	53	39	29
Deflection [mm]	10	20	33	45	59	92	133	181	238	303	377
CPL [kg]	2085	1656	1368	1160	1002	777	623	509	420	303	287
Deflection [mm]	12	18	26	36	47	75	109	151	201	259	327
TPL [kg]	1412	1242	1026	870	752	583	467	382	315	261	216
Deflection [mm]	14	23	33	45	58	87	121	157	193	228	258
QPL [kg]	941	828	684	580	501	389	312	254	210	174	144
Deflection [mm]	13	22	31	41	53	81	112	146	179	211	240
FPL [kg]	706	684	570	483	418	324	260	212	175	145	120
Deflection [mm]	12	23	33	44	57	86	119	154	190	224	254
	13.12 ft	16.40 ft	19.69 ft	22.97 ft	26.25 ft	32.81 ft	39.37 ft	45.93 ft	52.49 ft	59.06 ft	65.62 ft
UDL [lbs/ft]	501.29	399.15	306.42	222.42	168.66	104.16	69.88	49.05	35.61	26.21	19.49
Deflection [in]	0.39	0.79	1.30	1.77	2.32	3.62	5.24	7.13	9.37	11.93	14.84
CPL [lbs]	4596.64	3650.86	3015.92	2557.36	2209.03	1712.99	1373.48	1122.15	925.94	668.00	632.73
Deflection [in]	0.47	0.71	1.02	1.42	1.85	2.95	4.29	5.94	7.91	10.20	12.87
TPL [lbs]	3112.93	2738.14	2261.94	1918.02	1657.88	1285.29	1029.56	842.17	694.46	575.41	476.20
Deflection [in]	0.55	0.91	1.30	1.77	2.28	3.43	4.76	6.18	7.60	8.98	10.16
QPL [lbs]	2074.55	1825.43	1507.96	1278.68	1104.52	857.60	687.84	559.97	462.97	383.60	317.47
Deflection [in]	0.51	0.87	1.22	1.61	2.09	3.19	4.41	5.75	7.05	8.31	9.45
FPL [lbs]	1556.46	1507.96	1256.63	1064.83	921.53	714.30	573.20	467.38	385.81	319.67	264.55
Deflection [in]	0.47	0.91	1.30	1.73	2.24	3.39	4.69	6.06	7.48	8.82	10.00

Loading tables are valid for static loads and spans with two supporting points. Spans must be supported at each end. Contact structural engineer if there are more supporting points applied or dynamic and wind loads involved.

High values of distributed loads are idealized. Loads must be applied to knot points!

\* The truss may be loaded only at the points of vertical diagonals – intersections load only. Only vertical loads – the force vector must always aim directly to the ground.

## LOADING TABLES – CENTRAL SPECIAL TUBE

	4 m	5 m	6 m	7 m	8 m	10 m	12 m	14 m	16 m	18 m	20 m
UDL [kg/m]	746	594	456	331	251	155	104	73	53	39	29
Deflection [mm]	10	20	33	45	59	92	133	181	238	303	377
CPL [kg]	800	800	800	800	800	777	623	509	420	348	287
Deflection [mm]	5	9	16	26	39	75	109	151	201	259	327
TPL [kg]	800	800	800	800	752	583	467	382	315	261	216
Deflection [mm]	8	15	26	41	58	87	121	157	193	228	258
QPL [kg]	800	800	684	580	501	389	312	254	210	174	144
Deflection [mm]	11	21	31	41	53	81	112	146	179	211	240
FPL [kg]	706	684	570	483	418	324	260	212	175	145	120
Deflection [mm]	12	23	33	44	57	86	119	154	190	224	254
	13.12 ft	16.40 ft	19.69 ft	22.97 ft	26.25 ft	32.81 ft	39.37 ft	45.93 ft	52.49 ft	59.06 ft	65.62 ft
UDL [lbs/ft]	501.29	399.15	306.42	222.42	168.66	104.16	69.88	49.05	35.61	26.21	19.49
Deflection [in]	0.39	0.79	1.30	1.77	2.32	3.62	5.24	7.13	9.37	11.93	14.84
CPL [lbs]	1763.70	1763.70	1763.70	1763.70	1763.70	1712.99	1373.48	1122.15	925.94	767.21	632.73
Deflection [in]	0.20	0.35	0.63	1.02	1.54	2.95	4.29	5.94	7.91	10.20	12.87
TPL [lbs]	1763.70	1763.70	1763.70	1763.70	1657.88	1285.29	1029.56	842.17	694.46	575.41	476.20
Deflection [in]	0.31	0.59	1.02	1.61	2.28	3.43	4.76	6.18	7.60	8.98	10.16
QPL [lbs]	1763.70	1763.70	1507.96	1278.68	1104.52	857.60	687.84	559.97	462.97	383.60	317.47
Deflection [in]	0.43	0.83	1.22	1.61	2.09	3.19	4.41	5.75	7.05	8.31	9.45
FPL [lbs]	1556.46	1507.96	1256.63	1064.83	921.53	714.30	573.20	467.38	385.81	319.67	264.55
Deflection [in]	0.47	0.91	1.30	1.73	2.24	3.39	4.69	6.06	7.48	8.82	10.00