

SIZE IN MILLIMETERS

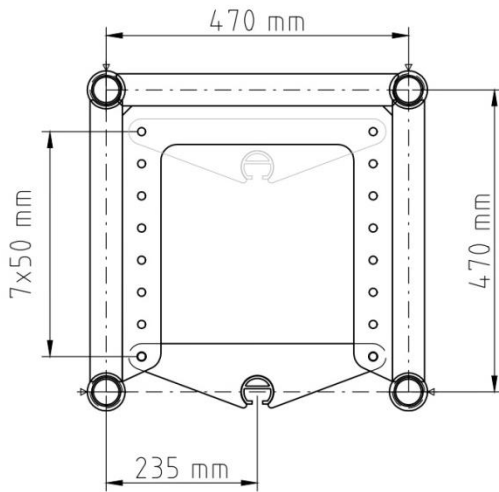

SIZE IN INCHES

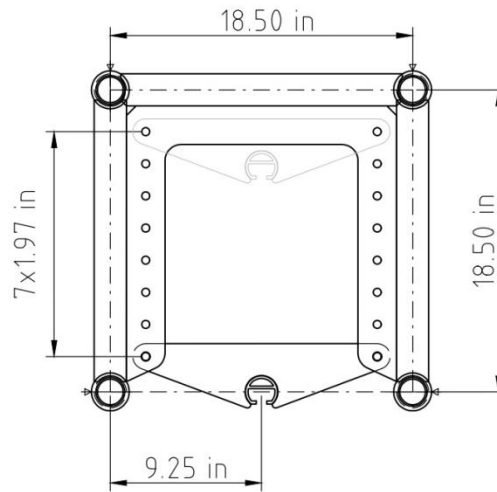

SPECIFICATIONS

Tubes	50 x 4 mm (1.97 x 0.16 in)
Braces	30 x 3 mm (1.18 x 0.12 in)
Alloy	EN AW-6082 T6

LOADING TABLES – COMPLETE TRUSS

	4 m	5 m	6 m	7 m	8 m	10 m	12 m	14 m	16 m	18 m	20 m
UDL [kg/m]	1399	1116	927	687	521	327	222	158	117	89	68
Deflection [mm]	5	10	17	24	32	49	71	97	128	162	201
CPL [kg]	2794	2470	2211	1998	1821	1541	1330	1107	935	797	683
Deflection [mm]	4	7	11	16	22	38	58	80	106	136	170
TPL [kg]	1672	1512	1379	1265	1168	1010	886	787	701	598	512
Deflection [mm]	4	7	12	17	24	40	61	85	113	138	162
QPL [kg]	1115	1008	919	843	779	673	591	525	467	398	342
Deflection [mm]	4	7	11	16	22	37	56	79	105	128	151
FPL [kg]	870	792	725	668	619	538	474	423	380	332	285
Deflection [mm]	4	7	11	16	22	38	58	81	109	136	160
	13.12 ft	16.40 ft	19.69 ft	22.97 ft	26.25 ft	32.81 ft	39.37 ft	45.93 ft	52.49 ft	59.06 ft	65.62 ft
UDL [lbs/ft]	940.09	479.92	622.92	461.64	350.10	219.73	149.18	106.18	78.62	59.81	45.69
Deflection [in]	0.20	0.39	0.67	0.94	1.26	1.93	2.80	3.82	5.04	6.38	7.91
CPL [lbs]	6159.72	5445.42	4874.42	4404.84	4014.62	3397.32	2932.15	2440.52	2061.32	1757.08	1505.76
Deflection [in]	0.16	0.28	0.43	0.63	0.87	1.50	2.28	3.15	4.17	5.35	6.69
TPL [lbs]	3685.63	3332.94	3039.76	2788.47	2574.65	2226.37	1953.03	1734.80	1545.23	1318.18	1128.61
Deflection [in]	0.16	0.28	0.47	0.67	0.94	1.57	2.40	3.35	4.45	5.43	6.38
QPL [lbs]	2458.15	2222.26	2026.05	1858.50	1717.40	1483.71	1302.93	1157.43	1029.56	877.44	753.98
Deflection [in]	0.16	0.28	0.43	0.63	0.87	1.46	2.20	3.11	4.13	5.04	5.94
FPL [lbs]	1918.02	1746.06	1598.35	1472.69	1364.66	1186.09	1044.99	932.56	837.76	731.93	628.32
Deflection [in]	0.16	0.28	0.43	0.63	0.87	1.50	2.28	3.19	4.29	5.35	6.30

Loading tables are valid for static loads and spans with two supporting points. Spans must be supported at each end. Contact structural engineer if there are more supporting points applied or dynamic and wind loads involved.

High values of distributed loads are idealized. Loads must be applied to knot points!

* The truss may be loaded only at the points of vertical diagonals – intersections load only. Only vertical loads – the force vector must always aim directly to the ground.

LOADING TABLES – CENTRAL SPECIAL TUBE

	4 m	5 m	6 m	7 m	8 m	10 m	12 m	14 m	16 m	18 m	20 m
UDL [kg/m]	600	600	600	600	521	327	222	158	117	89	68
Deflection [mm]	3	7	15	24	32	49	71	97	128	162	201
CPL [kg]	600	600	600	600	600	600	600	600	600	600	600
Deflection [mm]	1	2	4	7	10	21	37	61	93	136	170
TPL [kg]	600	600	600	600	600	600	600	600	600	598	512
Deflection [mm]	2	4	7	11	16	32	55	85	113	138	162
QPL [kg]	600	600	600	600	600	600	591	525	467	398	342
Deflection [mm]	3	6	10	15	22	37	56	79	105	128	151
FPL [kg]	600	600	600	600	600	538	474	423	380	332	285
Deflection [mm]	4	7	11	16	22	38	58	81	109	136	160
	13.12 ft	16.40 ft	19.69 ft	22.97 ft	26.25 ft	32.81 ft	39.37 ft	45.93 ft	52.49 ft	59.06 ft	65.62 ft
UDL [lbs/ft]	403.18	403.18	403.18	403.18	350.10	219.73	149.18	106.17	78.62	59.81	45.36
Deflection [in]	0.12	0.28	0.59	0.94	1.26	1.93	2.80	3.82	5.04	6.38	7.91
CPL [lbs]	1322.77	1322.77	1322.77	1322.77	1322.77	1322.77	1322.77	1322.77	1322.77	1322.77	1322.77
Deflection [in]	0.04	0.08	0.16	0.28	0.39	0.83	1.16	2.40	3.66	5.35	6.69
TPL [lbs]	1322.77	1322.77	1322.77	1322.77	1322.77	1322.77	1322.77	1322.77	1322.77	1318.18	1128.61
Deflection [in]	0.08	0.16	0.28	0.43	0.63	1.26	2.17	3.35	4.45	5.43	6.38
QPL [lbs]	1322.77	1322.77	1322.77	1322.77	1322.77	1322.77	1302.93	1157.43	1029.56	877.44	753.98
Deflection [in]	0.12	0.24	0.39	0.59	0.87	1.46	2.20	3.11	4.13	5.04	5.94
FPL [lbs]	1322.77	1322.77	1322.77	1322.77	1322.77	1186.09	1044.99	932.56	837.76	731.93	628.32
Deflection [in]	0.16	0.28	0.43	0.63	0.87	1.50	2.28	3.19	4.29	5.35	6.30